

# Complete Table of KWM Bronze Friction Bushing (American Made)

Order Number for bushing is SBB72.B57 Sample of the part Number

KWM Bronze Bushing Refills..... Pkg. 20 pc. ... 1 to 5 pkg. \$ 4.75 pkg. ... 6 to 11 \$ 4.50 pkg. ... 12 or more \$ 4.25 pkg.

Z Pivot Diameter	B B o r e R N	H D R N	1.0		1.4					1.7	1.9			2.7					3.0	4.0
			1.2	1.8	1.8	2.7	3.5	4.7	5.9	5.9	1.8	2.7	3.5	1.8	2.7	3.5	4.7	5.9	8.7	8.7
			1.18	1.78	1.78	2.68	3.48	4.66	5.85	5.85	1.78	2.68	3.48	1.78	2.68	3.48	4.66	5.85	8.64	8.64
			I	II	II	III	IV	IVa	V	V	II	III	IV	II	III	IV	IVa	V	VI	VI
0.07-0.08	0.1		B55																	
0.10-0.12	0.15		B56																	
0.15-0.17	0.2		B01																	
0.19-0.21	0.25		B57																	
0.23-0.25	0.3		B02		B64						B86									
0.27-0.30	0.35		B58																	
0.32-0.35	0.4		B03		B08						B87									
0.38-0.40	0.45		B59																	
0.42-0.45	0.5		B04		B09						B32			B94						
0.48-0.50	0.55		B60																	
0.53-0.55	0.6		B05		B10						B33			B95						
0.57-0.60	0.7		B06		B11						B34			B96						
0.65-0.70	0.8		B07		B12						B35			B97						
0.75-0.80	0.9			B61	B13						B36			B98						
0.85-0.90	1.0			B62	B65	B14					B37				B99					
0.95-1.00	1.1			B63	B66	B15						B38			B100					
1.05-1.10	1.2					B16						B39			B101					
1.15-1.20	1.3					B17						B40			B102					
1.25-1.30	1.4					B18						B41			B103					
1.35-1.40	1.5					B19						B42			B104					
1.45-1.50	1.6					B20						B43			B105					
1.55-1.60	1.7					B67						B88			B106					
1.65-1.70	1.8					B21						B44			B107					
1.75-1.80	1.9					B68						B89			B108					
1.85-1.90	2.0						B22						B45			B109				
1.95-2.00	2.1						B69						B90			B110				
2.05-2.10	2.2						B23						B46			B111				
2.15-2.20	2.3						B70						B91			B112				
2.25-2.30	2.4						B24						B47			B113				
2.35-2.40	2.5						B71						B92			B114				
2.45-2.50	2.6						B25						B48			B115				
2.55-2.60	2.7						B72						B93			B116				
2.65-2.70	2.8						B26						B49			B117				
2.75-2.80	2.9							B138	B73	B80							B143			
2.85-2.90	3.0							B139	B27	B50							B144	B118		
2.95-3.05	3.2							B140	B28	B51							B145	B119		
3.10-3.25	3.4							B141	B74	B81							B146	B120		
3.30-3.45	3.6							B142	B29	B52							B147	B121		
3.55-3.65	3.8								B75	B82								B122		
3.75-3.85	4.0								B76	B83								B123		
3.90-4.05	4.2								B30	B53								B124		
4.15-4.25	4.4								B77	B84								B125		
4.35-4.45	4.6								B31	B54								B126		
4.55-4.65	4.8								B78	B85								B127		
4.75-4.85	5.0																		B128	
5.00-5.05	5.2																		B129	
5.15-5.25	5.4																		B130	
5.35-5.45	5.6																		B131	
5.55-5.65	5.8																		B132	
5.75-5.85	6.0																		B133	
5.95-6.05	6.2																		B134	
6.15-6.25	6.4																		B135	
6.35-6.45	6.6																		B136	
6.55-6.65	6.8																		B137	

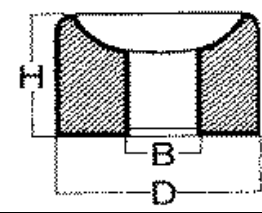

**How to use this chart**  
 The numbers prefixed by the letter "B" such as B57 in the chart indicates the bushing number. The number serves as a refill number for various assortments. To select the correct bushing, first Measure the pivot, & find it size in the range of sizes shown in column Z. By reading across, you Will find the various bushing that Will fit the size pivot. Select the thickness of bushing by Referring to letter "H" & the correct diameter by the letter "D". After choosing the bushing, read Up the column to line "RN" which indicates the size reamer to Be used for the selected bushing. Reamers are identified by Roman numerals.

Prices Subject To Change Without Notice.