

# Complete Table of KWM Brass Friction Bushing (German Made)

**KWM Brass Bushing Refills**..... Pkg. 20 pc. Sizes 72.001 to 72.127, and 72.138 to 72.147 ... 1 to 11 pkg. \$ 9.75 pkg.  
 12 pkg. or more \$ 9.50 pkg.      Sizes 72.128 to 72.137 pkg of 10 pc. 1 to 11 \$ 16.50 pkg. 12 pkg or more \$ 16.25 pkg.

Z Pivot Diameter	B B o r e	H D R R N	1.0		1.4					1.7	1.9			2.7						3.0	4.0
			1.2	1.8	1.8	2.7	3.5	4.7	5.9	5.9	1.8	2.7	3.5	1.8	2.7	3.5	4.7	5.9	8.7	8.7	
			1.18	1.78	1.78	2.68	3.48	4.66	5.85	5.85	1.78	2.68	3.48	1.78	2.68	3.48	4.66	5.85	8.64	8.64	
			I	II	II	III	IV	IVa	V	V	II	III	IV	II	III	IV	IVa	V	VI	VI	
0.07-0.08	0.1		L55																		
0.10-0.12	0.15		L56																		
0.15-0.17	0.2		L01																		
0.19-0.21	0.25		L57																		
0.23-0.25	0.3		L02		L64						L86										
0.27-0.30	0.35		L58																		
0.32-0.35	0.4		L03		L08						L87										
0.38-0.40	0.45		L59																		
0.42-0.45	0.5		L04		L09						L32			L94							
0.48-0.50	0.55		L60																		
0.53-0.55	0.6		L05		L10						L33			L95							
0.57-0.60	0.7		L06		L11						L34			L96							
0.65-0.70	0.8		L07		L12						L35			L97							
0.75-0.80	0.9			L61	L13						L36			L98							
0.85-0.90	1.0			L62	L65	L14					L37				L99						
0.95-1.00	1.1			L63	L66	L15						L38		L100							
1.05-1.10	1.2					L16						L39		L101							
1.15-1.20	1.3					L17						L40		L102							
1.25-1.30	1.4					L18						L41		L103							
1.35-1.40	1.5					L19						L42		L104							
1.45-1.50	1.6					L20						L43		L105							
1.55-1.60	1.7					L67						L88		L106							
1.65-1.70	1.8					L21						L44		L107							
1.75-1.80	1.9					L68						L89		L108							
1.85-1.90	2.0						L22						L45		L109						
1.95-2.00	2.1						L69						L90		L110						
2.05-2.10	2.2						L23						L46		L111						
2.15-2.20	2.3						L70						L91		L112						
2.25-2.30	2.4						L24						L47		L113						
2.35-2.40	2.5						L71						L92		L114						
2.45-2.50	2.6						L25						L48		L115						
2.55-2.60	2.7						L72						L93		L116						
2.65-2.70	2.8						L26						L49		L117						
2.75-2.80	2.9							L138	L73	L80						L143					
2.85-2.90	3.0							L139	L27	L50						L144	L118				
2.95-3.05	3.2							L140	L28	L51						L145	L119				
3.10-3.25	3.4							L141	L74	L81						L146	L120				
3.30-3.45	3.6							L142	L29	L52						L147	L121				
3.55-3.65	3.8								L75	L82							L122				
3.75-3.85	4.0								L76	L83							L123				
3.90-4.05	4.2								L30	L53							L124				
4.15-4.25	4.4								L77	L84							L125				
4.35-4.45	4.6								L31	L54							L126				
4.55-4.65	4.8								L78	L85							L127				
4.75-4.85	5.0																	L128			
5.00-5.05	5.2																	L129			
5.15-5.25	5.4																	L130			
5.35-5.45	5.6																	L131			
5.55-5.65	5.8																	L132			
5.75-5.85	6.0																	L133			
5.95-6.05	6.2																			L134	
6.15-6.25	6.4																			L135	
6.35-6.45	6.6																			L136	
6.55-6.65	6.8																			L137	

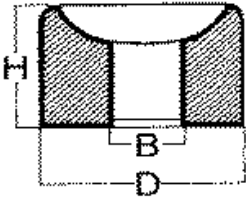

**How to use this chart**  
 The numbers prefixed by the letter "L" such as L57 in the chart indicates the bushing number.  
 The number serves as a refill number for various assortments.  
 To select the correct bushing, first measure the pivot, & find its size in the range of sizes shown in column Z. By reading across, you will find the various bushing that will fit the size pivot.  
 Select the thickness of bushing by referring to letter "H" & the correct diameter by the letter "D".  
 After choosing the bushing, read up the column to line "RN" which indicates the size reamer to be used for the selected bushing. Reamers are identified by Roman numerals.

Prices Subject To Change Without Notice.